

# Roller Team Pegaso 740

**Just landed \$209,900 Drive away**

The Roller Team Pegaso 740 invites you to experience travel like never before. As a testament to Italian craftsmanship, this A-Class motorhome seamlessly blends luxury with functionality, making it an ideal choice for couples and small families seeking an extraordinary journey.

Built on the Fiat Cab, the 740 offers not only superior drivability but also a striking, modern aesthetic. The sleek design and sophisticated styling reflect the finest in Italian engineering and craftsmanship, promising both a smooth ride and an eye-catching presence on the road.

Unmatched Comfort and Versatility: Whether you're embarking on a weekend getaway or a longer adventure, the large rear boot can fit all the sports gear with flex-space technology for those larger items. Its thoughtful layout and premium amenities provide a home away from home, ensuring that every journey is both enjoyable and memorable.

## Facts & Figures

<b>Build Year</b>	2024
<b>Km's</b>	200 kms – new motorhome
<b>Driven on</b>	Car Licence
<b>WOF/COF</b>	COF
<b>Berth</b>	4 Berth
<b>Cab/Chassis</b>	Fiat Ducato
<b>Engine</b>	Euro 6D
<b>Horsepower</b>	180 BHP
<b>Transmission</b>	9 Speed Automatic
<b>Maximum gross weight</b>	3650 Kgs
<b>Mass in running order</b>	3138 Kgs
<b>Payload</b>	512 Kgs
<b>Length</b>	7.41mm
<b>Width</b>	2.35m
<b>Height</b>	2.95m
<b>Wheels</b>	16" Alloys

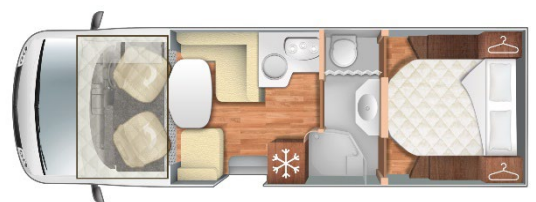

## Living room

- Diesel/electric heating
- Double glazed windows fitted with Roman blinds and flyscreens
- Skylight on roof
- Grade 3 insulation
- Cushioned vinyl flooring with removeable carpets
- Integrated entrance door with fixed window + flyscreen and remote locking

## Kitchen



**ROLLER TEAM**

3 Way Fridge with Freezer compartment
Thetford duplex gas oven with grill function
Thetford 3 x hob gas stove
<b>Bed Dimensions</b>
Rear bed – 1900mm x 1500mm
Overcab bed – 1850mm x 1340mm
<b>Water and Plumbing</b>
100 litres fresh water
100 litres grey water
Truma iNet Control Panel
Separate shower and toilet
12v electric flush toilet
<b>Exterior</b>
Awning
1 x 120w Solar Panel
Bike rack for four bikes – Max capacity 60 kgs
1x 9kg gas bottle
<b>Cab area</b>
Cab air conditioning
Upgraded Pioneer touch screen head unit
Reversing camera
Pleated cab blinds
Driver and passenger swivel seats
<b>Safety Features</b>
Drivers and Passenger Airbags
ABS braking
Remote central locking
Disc brakes front and rear
Engine immobiliser
Fire extinguisher, CO <sup>2</sup> + smoke alarms
Flame failure shut off valves to all gas appliances
Electronic traction control system
Cruise control with speed limiter



See me online at [www.nationwiderv.co.nz](http://www.nationwiderv.co.nz)



- *2 Year Fiat Mechanical Warranty*
- *5 Year Water Ingress Warranty*
- *2 Year Habitation Warranty*
- *Terms and Conditions apply*

2 Flexman Place  
**Silverdale**  
[mike@nationwiderv.co.nz](mailto:mike@nationwiderv.co.nz)  
 Phone: 09 930 6353

85 Great South Road  
**Pokeno**  
[malcolm@nationwiderv.co.nz](mailto:malcolm@nationwiderv.co.nz)  
 Phone: 09 294 6500

686 Devon Road  
**New Plymouth**  
[kane@nationwiderv.co.nz](mailto:kane@nationwiderv.co.nz)  
 Phone: 06 758 0984

131 Archibald Street  
**Ashburton**  
[lance@nationwiderv.co.nz](mailto:lance@nationwiderv.co.nz)  
 Phone: 03 307 8037